

ADDENDUM NUMBER 01 TO THE BID DOCUMENTS

To all general contract bidders of record on the Bid Proposal:

**BID DOCUMENT: 17/18 MB5
Building 11 Renovation # I50-35613
College of Marin – Indian Valley Campus**

Addendum Date: October 9, 2017

- A. This addendum shall be considered part of the bid documents for the above mentioned project as though it had been issued at the same time and shall be incorporated integrally therewith. Where provisions of the following supplementary data differ from those of the original bid documents, this Addendum shall govern and take precedence.
- B. Bidders are hereby notified that they shall make any necessary adjustments in their estimates as a result of this Addendum. It will be construed that each bidder's proposal is submitted with full knowledge of all modifications and supplemental data specified herein.

The bid documents are modified and clarified, as follows:

Item #1: Drawing sheet A9.20 Elevator Details

Detail: 1/A9,20 Elevator Floor Plan

- Added language to provide two-way communication device per CBC 1009.8.
- Added language for Directions for two-way communication device per CBC 1009.8.2
- Added 30"x48" clear floor space at elevator hall control per CBC 11B-407.2.1.3

Item #2: Drawing sheet A9.21 Elevator Details

Detail 1/A9.21 Elevator Cab Back Wall Elevation

- Added notation for 6" max clearance for handrail
- Clarified mounting height for handrail
- Removed car indicator from back wall

Detail 2/A9.21 Elevator Cab Side Elevation

- Added language for car position indicator per CBC 11B-407.4.8

Detail 4/A9.21 Elevator Door Sill - Wood

- Added clearance dim. at elevator and hoistway transition
- Clarified flooring material at elevator and existing adjacent flooring

Detail 5/A9.21 Elevator Door Sill - Concrete

- Added language for elevator cab surface per CBC 11B-407.4.4
- Added clearance dim. at elevator and hoistway transition

Detail 6/A9.21 Elevator Support Rail

- Added language for stainless steel handrail allowable stresses and mounting requirements inside elevator cab.

Detail 7/A9.21 Floor Designation Signage

- Clarified that international symbol for emergency need to be 2" high on signage

Detail 8/A9.21 Elevator Control Panel

- Clarified elevator control panel button requirements

Detail 10/A9.21 Elevator specifications

- Added existing elevator information and Code requirements for elevator control and devices for replacement work

Item #3: Missing Specification Sections

Added missing spec section 06 40 05 Exterior Finish Carpentry
Added missing spec section 09 65 19 Resilient Tile Flooring

MATT COMBRINK
Name of Architect or Engineer in General Responsible Charge

[Signature] 10-5-17
Signature of Architect or Structural Engineer Date



Attachments issued with Addendum 01:

Drawing sheet A9.20

Drawing sheet A9.21

Spec Section 06 40 05 Exterior Finish Carpentry

Spec Section 09 65 19 Resilient Tile Flooring

End of Addendum #01



State of California
 DEPARTMENT OF GENERAL SERVICES
 DIVISION OF THE STATE ARCHITECT
 1515 Clay Street, Suite 1201 • Oakland • California 94612
 Phone (510) 622-3101 • Fax (510) 622-3140

www.dsa.dgs.ca.gov

Addendum, Change Order,
 Drawing, Deferred Approval
 Worksheet and Transmittal Memo

New Resubmittal Date Sent: 10-5-17 File # 21-C1 01-116787

Job COLLEGE OF MARIN

Addendum Number	Deferred Submittal	Preliminary Change Order	Change Order Number	Other
-----------------	--------------------	--------------------------	---------------------	-------

List of Material Received:	A. Master Copy			
	B. Copies 3 sets			
	C. Tracing(s) each	of Sheets(s) Numbers(s)		
	D. Prints(s) each	of Sheets(s) Numbers(s)		
	E.			
	F.			

List of Material Approved: ADDENDUM 1

List of Material

To: Architect Structural Engineer
 Name: MATTISON 4
 Address: BRICK

To:	From:
Co.	No. of Pages
Fax No.	Phone No.

Copies REC'D MATTISON DATE: 10/05/2017

Remaining Requirements:

Corrections Required Change Order Required

If Corrections are required, please submit the following:

- 1) Intact marked up check set.
- 2) This transmittal memo.
- 3) Two corrected copies of submittal.
- 4) Calculations and other back-up information.
- 5) Drawings bearing preliminary approval stamps to avoid re-review whenever possible.

Remarks:

Notes for Clerical Use

Please make file copy of: THIS TRANSMITTAL Other: FILE RECORD SET

Extend Plans and specs approval to cover:

Only: Revised Plans and Specs.
 Additional: Plans and Specs. Scope increase: _____ Type of Approval: _____

Checked by	ACS <input type="checkbox"/> Not Required <u>R. EDGMAN.</u>	FLS <input type="checkbox"/> Not Required <u>[Signature]</u>	SSS <input type="checkbox"/> Not Required <u>M. GRETZ</u>
Approved by	<u>[Signature]</u>	<u>[Signature]</u>	<u>[Signature]</u>
Date	<u>10/5/2017.</u>	<u>10-5-2017</u>	<u>10-5-17</u>

SECTION 06 40 05

EXTERIOR FINISH CARPENTRY

PART 1 - GENERAL

1.1 SUMMARY

- A. Work Included: Exterior Finish Carpentry, complete, as shown and specified.
- B. Work Specified Elsewhere:
 - 1. Interior Architectural Woodwork: Section 06 40 23.

1.2 SUBMITTALS

- A. Product Data: Submit for College of Marin Representative's action. Submit manufacturer's literature and installation instructions for each material and accessory, clearly notating each specified requirement.
- B. Shop Drawings: Submit for College of Marin Representative's action. Prepare details at a scale not less than 3 in. = 1 ft. Coordinate shop drawings with assemblies in Work Specified Elsewhere.
- C. Samples: Submit for College of Marin Representative's action. Label samples to indicate product, characteristics, and location in the Work. Samples will be reviewed for color and appearance only. Furnish sufficient samples to establish the full range of colors and textures for materials exposed in the finished work. Compliance with other requirements is the responsibility of the Contractor.
 - 1. Actual width by 12 in. long.
- D. Quality Assurance/Quality Control Submittals: Submit for College of Marin Representative's information.
 - 1. Certificates:
 - a. Installer's Qualifications.

1.3 QUALITY ASSURANCE

- A. Qualified Installer: Installer to have 5 years experience in the installation of specified materials on comparable projects. The firm shall have the approval of the materials manufacturer.
- B. Regulatory Requirements: Comply with applicable requirements of the laws, codes, and regulations of Authorities Having Jurisdiction (AHJs). Obtain necessary approvals from AHJs.
- C. Must meet 2016 California Building Code Chapter 7A Section 707A.

1.4 DELIVERY, STORAGE, AND HANDLING

SECTION 09 65 19

RESILIENT TILE FLOORING

PART 1 - GENERAL

1.1 RELATED DOCUMENTS

- A. ~~Drawings and general provisions of the Contract, including General and Supplementary Conditions and Division 01 Specification Sections, apply to this Section.~~

1.2 SUMMARY

- A. Section Includes:
1. Rubber floor tile.
- B. Related Sections:
1. Section 09 65 13 "Resilient Base and Accessories."

1.3 ACTION SUBMITTALS

- A. Product Data: For each type of product.
- B. Shop Drawings: For each type of floor tile. Include floor tile layouts, edges, columns, doorways, enclosing partitions, built-in furniture, cabinets, and cutouts.
1. Show details of special patterns.
- C. Samples: Full-size units of each color and pattern of floor tile required.
- D. Samples for Initial Selection: For each type of floor tile indicated.
- E. Samples for Verification: Full-size units of each color and pattern of floor tile required.
- F. Product Schedule: For floor tile. Use same designations indicated on Drawings.

1.4 INFORMATIONAL SUBMITTALS

- A. Qualification Data: For Installer.

1.5 CLOSEOUT SUBMITTALS

- A. Maintenance Data: For each type of floor tile to include in maintenance manuals.

PART 2 - PRODUCTS

2.1 PERFORMANCE REQUIREMENTS

- A. Fire-Test-Response Characteristics: For resilient tile flooring, as determined by testing identical products according to ASTM E 648 or NFPA 253 by a qualified testing agency.
 - 1. Critical Radiant Flux Classification: Class I, not less than 0.45 W/sq. cm.

2.2 LINOLEUM TILE

- A. R1 - reception area: Forbo "Marmoleum Black Hole T3707", or equal as approved by the District.
- B. R2- kitchen: Forbo "Marmoleum Graphite T3048", or equal as approved by the District.

2.3 INSTALLATION MATERIALS

- A. Trowelable Leveling and Patching Compounds: Latex-modified, portland cement based or blended hydraulic-cement-based formulation provided or approved by floor tile manufacturer for applications indicated.
- B. Adhesives: Water-resistant type recommended by floor tile and adhesive manufacturers to suit floor tile and substrate conditions indicated.

PART 3 - EXECUTION

3.1 EXAMINATION

- A. Examine substrates, with Installer present, for compliance with requirements for maximum moisture content and other conditions affecting performance of the Work.
 - 1. Verify that finishes of substrates comply with tolerances and other requirements specified in other Sections and that substrates are free of cracks, ridges, depressions, scale, and foreign deposits that might interfere with adhesion of floor tile.
- B. Proceed with installation only after unsatisfactory conditions have been corrected.

3.2 PREPARATION

- A. Prepare substrates according to floor tile manufacturer's written instructions to ensure adhesion of resilient products.
- B. Concrete Substrates: Prepare according to ASTM F 710.
 - 1. Verify that substrates are dry and free of curing compounds, sealers, and hardeners.

- C. Protect floor tile from mars, marks, indentations, and other damage from construction operations and placement of equipment and fixtures during remainder of construction period.
- D. Cover floor tile until Substantial Completion.

END OF SECTION

SECTION 06 40 05

EXTERIOR FINISH CARPENTRY

PART 1 - GENERAL

1.1 SUMMARY

- A. Work Included: Exterior Finish Carpentry, complete, as shown and specified.
- B. Work Specified Elsewhere:
 - 1. Interior Architectural Woodwork: Section 06 40 23.

1.2 SUBMITTALS

- A. Product Data: Submit for College of Marin Representative's action. Submit manufacturer's literature and installation instructions for each material and accessory, clearly notating each specified requirement.
- B. Shop Drawings: Submit for College of Marin Representative's action. Prepare details at a scale not less than 3 in. = 1 ft. Coordinate shop drawings with assemblies in Work Specified Elsewhere.
- C. Samples: Submit for College of Marin Representative's action. Label samples to indicate product, characteristics, and location in the Work. Samples will be reviewed for color and appearance only. Furnish sufficient samples to establish the full range of colors and textures for materials exposed in the finished work. Compliance with other requirements is the responsibility of the Contractor.
 - 1. Actual width by 12 in. long.
- D. Quality Assurance/Quality Control Submittals: Submit for College of Marin Representative's information.
 - 1. Certificates:
 - a. Installer's Qualifications.

1.3 QUALITY ASSURANCE

- A. Qualified Installer: Installer to have 5 years experience in the installation of specified materials on comparable projects. The firm shall have the approval of the materials manufacturer.
- B. Regulatory Requirements: Comply with applicable requirements of the laws, codes, and regulations of Authorities Having Jurisdiction (AHJs). Obtain necessary approvals from AHJs.
- C. Must meet 2016 California Building Code Chapter 7A Section 707A.

1.4 DELIVERY, STORAGE, AND HANDLING

- A. Delivery: Do not deliver exterior architectural woodwork until painting, finishing, and overhead work is complete in applicable spaces.
- B. Storage: Store architectural woodwork in building, out of the way of other construction activities, at a relative humidity of 50 percent to 55 percent at 70 degrees F.

PART 2 - PRODUCTS

2.1 MATERIALS

- A. Woodwork Summary: Exterior wood sunshades. Install Exterior Finish Carpentry on existing metal armatures.
- B. Exterior trellis slats: Resysta "Hollow Profile RESP3423412", or equal, as approved by the District. Finish: Burma. Made from polymers, rock salt, mineral oil, and rice husks.
 - 1. Class A fire rated.
 - 2. Finish prior to installation. Refer to Section 09 91 00 "Painting and Coating."

PART 3 - EXECUTION

3.1 GENERAL

- A. Manufacturer's Instructions: Prepare substrates and install the work, including components and accessories in accordance with the manufacturer's instructions, except where more stringent requirements are shown or specified. Examine the areas to receive the Work and remedy detrimental conditions.
- B. Field Dimensions: Verify dimensions and conditions in field and adjust Architectural Woodwork in the shop to accommodate field conditions.

3.2 INSTALLATION

- A. Installation Tolerances:
 - 1. Variation from Plane: Limit variation from plane or location shown to 1/8 in. in 10 ft.; 1/4 in. over total length.
 - 2. Alignment: Where surfaces abut in line and at corners and where surfaces are separated by less than 1/4 in., limit offset from true alignment to less than 1/32 in.
 - 3. Offsets In End-To-End Or Edge-To-Edge Alignment Of Consecutive Members: 1/16 in. maximum offset in any alignment.

3.3 ADJUSTING AND CLEANING

- A. Defective Work: Touch-up, refinish, or replace damaged, stained, scratched, or otherwise disfigured portions of the Work to the satisfaction of the College of Marin Representative.

3.4 PROTECTION

- A. General: Protect Exterior Architectural Woodwork against damage until Work is accepted.

END OF SECTION

SECTION 09 65 19

RESILIENT TILE FLOORING

PART 1 - GENERAL

1.1 RELATED DOCUMENTS

- A. ~~Drawings and general provisions of the Contract, including General and Supplementary Conditions and Division 01 Specification Sections, apply to this Section.~~

1.2 SUMMARY

- A. Section Includes:
1. Rubber floor tile.
- B. Related Sections:
1. Section 09 65 13 "Resilient Base and Accessories."

1.3 ACTION SUBMITTALS

- A. Product Data: For each type of product.
- B. Shop Drawings: For each type of floor tile. Include floor tile layouts, edges, columns, doorways, enclosing partitions, built-in furniture, cabinets, and cutouts.
1. Show details of special patterns.
- C. Samples: Full-size units of each color and pattern of floor tile required.
- D. Samples for Initial Selection: For each type of floor tile indicated.
- E. Samples for Verification: Full-size units of each color and pattern of floor tile required.
- F. Product Schedule: For floor tile. Use same designations indicated on Drawings.

1.4 INFORMATIONAL SUBMITTALS

- A. Qualification Data: For Installer.

1.5 CLOSEOUT SUBMITTALS

- A. Maintenance Data: For each type of floor tile to include in maintenance manuals.

1.6 MAINTENANCE MATERIAL SUBMITTALS

- A. Furnish extra materials that match products installed and that are packaged with protective covering for storage and identified with labels describing contents.

1.7 QUALITY ASSURANCE

- A. Installer Qualifications: A qualified installer who employs workers for this Project who are competent in techniques required by manufacturer for floor tile installation and seaming method indicated.

1. Engage an installer who employs workers for this Project who are trained or certified by floor tile manufacturer for installation techniques required.

- B. Mockups: Build mockups to verify selections made under Sample submittals and to demonstrate aesthetic effects and set quality standards for materials and execution.

1. Build mockups for floor tile including resilient base and accessories.
 - a. Size: Minimum 100 sq. ft. for each type, color, and pattern in locations directed by College of Marin Representative.
2. Approval of mockups does not constitute approval of deviations from the Contract Documents contained in mockups unless College of Marin Representative specifically approves such deviations in writing.
3. Subject to compliance with requirements, approved mockups may become part of the completed Work if undisturbed at time of Substantial Completion.

1.8 DELIVERY, STORAGE, AND HANDLING

- A. Store floor tile and installation materials in dry spaces protected from the weather, with ambient temperatures maintained within range recommended by manufacturer, but not less than 50 deg F or more than 90 deg F. Store floor tiles on flat surfaces.

1.9 FIELD CONDITIONS

- A. Maintain ambient temperatures within range recommended by manufacturer, but not less than 70 deg F or more than 95 deg F, in spaces to receive floor tile during the following time periods:

1. 48 hours before installation.
2. During installation.
3. 48 hours after installation.

- B. After installation and until Substantial Completion, maintain ambient temperatures within range recommended by manufacturer, but not less than 55 deg F or more than 95 deg F.

- C. Close spaces to traffic during floor tile installation.

- D. Close spaces to traffic for 48 hours after floor tile installation.

- E. Install floor tile after other finishing operations, including painting, have been completed.

PART 2 - PRODUCTS

2.1 PERFORMANCE REQUIREMENTS

- A. Fire-Test-Response Characteristics: For resilient tile flooring, as determined by testing identical products according to ASTM E 648 or NFPA 253 by a qualified testing agency.
 - 1. Critical Radiant Flux Classification: Class I, not less than 0.45 W/sq. cm.

2.2 LINOLEUM TILE

- A. R1 - reception area: Forbo "Marmoleum Black Hole T3707", or equal as approved by the District.
- B. R2- kitchen: Forbo "Marmoleum Graphite T3048", or equal as approved by the District.

2.3 INSTALLATION MATERIALS

- A. Trowelable Leveling and Patching Compounds: Latex-modified, portland cement based or blended hydraulic-cement-based formulation provided or approved by floor tile manufacturer for applications indicated.
- B. Adhesives: Water-resistant type recommended by floor tile and adhesive manufacturers to suit floor tile and substrate conditions indicated.

PART 3 - EXECUTION

3.1 EXAMINATION

- A. Examine substrates, with Installer present, for compliance with requirements for maximum moisture content and other conditions affecting performance of the Work.
 - 1. Verify that finishes of substrates comply with tolerances and other requirements specified in other Sections and that substrates are free of cracks, ridges, depressions, scale, and foreign deposits that might interfere with adhesion of floor tile.
- B. Proceed with installation only after unsatisfactory conditions have been corrected.

3.2 PREPARATION

- A. Prepare substrates according to floor tile manufacturer's written instructions to ensure adhesion of resilient products.
- B. Concrete Substrates: Prepare according to ASTM F 710.
 - 1. Verify that substrates are dry and free of curing compounds, sealers, and hardeners.

2. Remove substrate coatings and other substances that are incompatible with adhesives and that contain soap, wax, oil, or silicone, using mechanical methods recommended by floor tile manufacturer. Do not use solvents.
 3. Alkalinity and Adhesion Testing: Perform tests recommended by floor tile manufacturer. Proceed with installation only after substrate alkalinity falls within range recommended by flooring manufacturer.
 4. Moisture Testing: Proceed with installation only after substrates pass testing according to floor tile manufacturer's written recommendations.
- C. Immediately before installation, sweep and vacuum clean substrates to be covered by resilient floor tile.

3.3 FLOOR TILE INSTALLATION

- A. Comply with manufacturer's written instructions for installing floor tile.
- B. Lay out floor tiles from center marks established with principal walls, discounting minor offsets, so tiles at opposite edges of room are of equal width. Adjust as necessary to avoid using cut widths that equal less than one-half tile at perimeter.
- C. Match floor tiles for color and pattern by selecting tiles from cartons in the same sequence as manufactured and packaged, if so numbered. Discard broken, cracked, chipped, or deformed tiles.
- D. Scribe, cut, and fit floor tiles to butt neatly and tightly to vertical surfaces and permanent fixtures including built-in furniture, cabinets, pipes, outlets, and door frames.
- E. Extend floor tiles into toe spaces, door reveals, closets, and similar openings. Extend floor tiles to center of door openings.
- F. Maintain reference markers, holes, and openings that are in place or marked for future cutting by repeating on floor tiles as marked on substrates. Use chalk or other nonpermanent marking device.
- G. Install floor tiles on covers for telephone and electrical ducts, building expansion-joint covers, and similar items in finished floor areas. Maintain overall continuity of color and pattern between pieces of tile installed on covers and adjoining tiles. Tightly adhere tile edges to substrates that abut covers and to cover perimeters.
- H. Adhere floor tiles to flooring substrates using a full spread of adhesive applied to substrate to produce a completed installation without open cracks, voids, raising and puckering at joints, telegraphing of adhesive spreader marks, and other surface imperfections.

3.4 CLEANING AND PROTECTION

- A. Comply with manufacturer's written instructions for cleaning and protecting floor tile.
- B. Perform the following operations immediately after completing floor tile installation:
 1. Remove adhesive and other blemishes from exposed surfaces.
 2. Sweep and vacuum surfaces thoroughly.
 3. Damp-mop surfaces to remove marks and soil.

- C. Protect floor tile from mars, marks, indentations, and other damage from construction operations and placement of equipment and fixtures during remainder of construction period.
- D. Cover floor tile until Substantial Completion.

END OF SECTION

Copyright 2011 Brick, LLP. All Rights Reserved - These Plans and/or Specifications are intended for the sole benefit of the clients of Brick, LLP and may not be used, reused, copied, or reproduced in any form without the express written consent of Brick, LLP.
file:

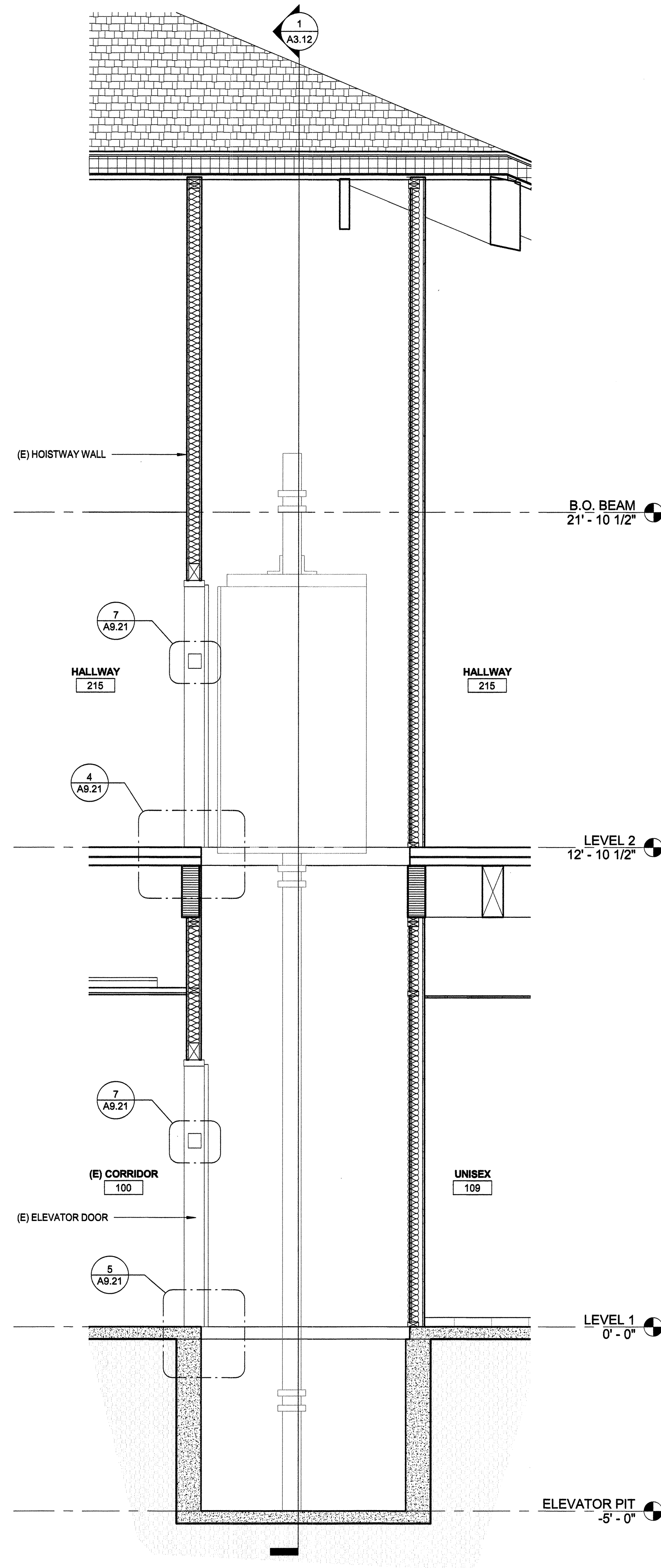

4 WALL SECTION AT ELEVATOR

1/2" = 1'-0"

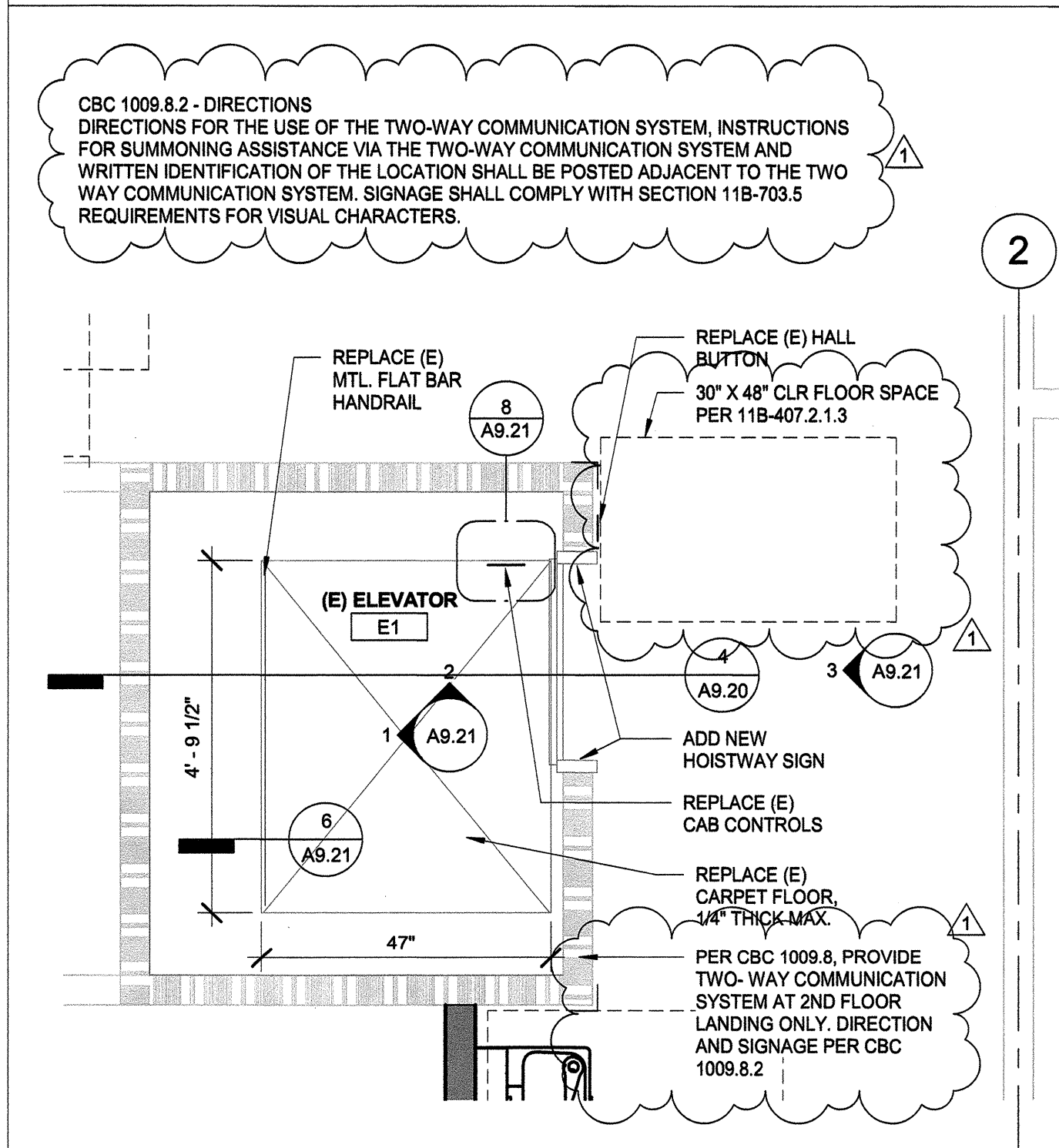

1 FLOOR PLAN - (E) FIRST FLOOR - ELEVATOR (2ND FLR.SIM.)

1/2" = 1'-0"

brick

ARCHITECT
brick,
1266 66th street, suite 1
emeryville, ca 94608
510.516.0187
www.brick-llp.com

CLIENT
marin community college district
835 college avenue
kentfield, ca 94904

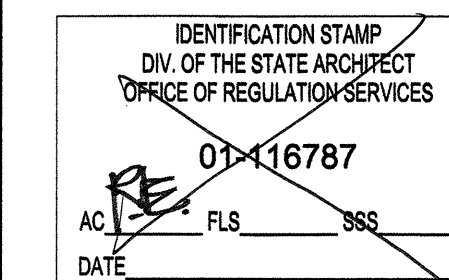

APPROVED
DIV. OF THE STATE ARCHITECT
AC. RE. FLS. EAC. SS. MTF
FILE NO. 01- DATE 10-5-17
116787

rev	date	issue
10/05/17		ADDENDUM 1
9/07/17		DSA BACK CHECK
5/31/17		DSA PLAN REVIEW
3/10/17		100% CD

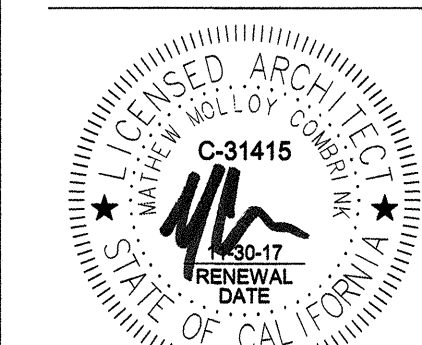

COM IVC Bldg. 11
renovation

novato, california
project number: 16-148.01

scale: as noted
date: 09/21/2017

CONSTRUCTION
DOCUMENTS
ELEVATOR
PLANS AND
SECTION

A9.20

EXISTING HYDRAULIC ELEVATOR SPEC:
 PIT AND HOISTWAY
 CAPACITY - 1500 LBS (MIN.)
 SPEED - 100 FEET PER MINUTE WITH FULL LOAD UP
 OPERATION - TWO STOP COLLECTIVE
 TRAVEL - 12'-9"
 POWER SUPPLY - 480 VOLTS, 3 PHASE, 60 CYCLE, 15 HP
 STOPS AND OPENINGS - 2 IN LINE
 CAB - HIGH PRESSURE LAMINATED PANELS MOUNTED ON STEEL SHELL. OVERHEAD LIGHTING ABOVE TRANSLUCENT PLASTIC SUSPENDED CEILING, BAKED ENAMEL CAR DOOR WITH STAINLESS STEEL KICK PLATE, FAN, AND EMERGENCY LIGHTING. HOISTWAY DOORS AND FRAMES - 2'-8" CLEAR X 7'-0" SINGLE SLIDING HOLLOW METAL WITH UNDERWRITERS "B" LABEL AND SQUARE FRAME ALL WITH BAKED-ON "BONE WHITE" ENAMEL PRIMER.
 DOOR OPERATION - DIRECT CURRENT POWER
 SPECIAL FEATURES - PAD HOOKS AND PROTECTION

PROVIDE THE FOLLOWING FOR NEW ELEVATOR CONTROL AND DEVICE REPLACEMENT:

PER CBC 11B-407.2.1.5 SIGNALS.
 CALL BUTTONS SHALL HAVE VISIBLE SIGNALS THAT WILL ACTIVATE WHEN EACH CALL IS REGISTERED AND WILL EXTINGUISH WHEN EACH CALL IS ANSWERED. CALL BUTTONS SHALL BE INTERNALLY ILLUMINATED WITH A WHITE LIGHT OVER THE ENTIRE SURFACE OF A BUTTON.

PER CBC 11B-407.2.2 HALL SIGNALS
 HALLS SIGNALS, INCLUDING IN-CAR SIGNALS SHALL COMPLY WITH SECTION 11B-407.2.2 11B-407.2.2.1 VISIBLE AND AUDIBLE SIGNALS
 A VISIBLE AND AUDIBLE SIGNAL SHALL BE PROVIDED AT EACH HOISTWAY ENTRANCE TO INDICATE WHICH CAR IS ANSWERING A CALL AND THAT CAR'S DIRECTION OF TRAVEL. WHERE IN-CAR SIGNALS ARE PROVIDED, THEY SHALL BE VISIBLE FROM THE FLOOR AREA ADJACENT TO THE HALL CALL BUTTONS.

11B-407.2.2.2 VISIBLE SIGNALS
 VISIBLE SIGNAL FIXTURES SHALL BE CENTERED AT 72 INCHES MIN. ABOVE THE FINISH FLOOR OR GROUND. THE VISIBLE SIGNAL ELEMENTS SHALL BE A MIN. 2 1/2 INCHES HIGH BY 2 1/2 INCHES WIDE. SIGNALS SHALL BE VISIBLE FROM THE FLOOR AREA ADJACENT TO THE HALL CALL BUTTON.

11B-407.2.2.3 AUDIBLE SIGNALS
 AUDIBLE SIGNALS SHALL SOUND ONCE FOR THE UP DIRECTION AND TWICE FOR THE DOWN DIRECTION, OR SHALL HAVE VERBAL ANNUNCIATIONS THAT INDICATE THE DIRECTION OF ELEVATOR CAR TRAVEL. AUDIBLE SIGNALS SHALL HAVE A FREQUENCY OF 1500 HERTZ MAX. VERBAL ANNUNCIATORS SHALL HAVE A FREQUENCY OF 300 HZ MIN. AND 3000 HZ MAX. THE AUDIBLE SIGNAL AND VERBAL ANNUNCIATOR SHALL BE 10 DB MIN ABOVE AMBIENT, BUT SHALL NOT EXCEED 90 DB. MEASURED AT THE HALL CALL BUTTON.

11B-407.3 ELEVATOR DOOR REQUIREMENTS

11B-407.3.2 OPERATION
 ELEVATOR HOISTWAY AND CAR DOORS SHALL OPEN AND CLOSE AUTOMATICALLY.

11B-407.3.3 REOPENING DEVICE
 ELEVATOR DOORS SHALL BE PROVIDED WITH A REOPENING DEVICE COMPLYING WITH SECTION 11B-407.3.3 THAT SHALL STOP AND REOPEN A CAR DOOR AND HOISTWAY DOOR AUTOMATICALLY IF THE DOOR BECOMES OBSTRUCTED BY AN OBJECT OR PERSON.

11B-407.3.3.1 HEIGHT
 THE DEVICE SHALL BE ACTIVATED BY SENSING AN OBSTRUCTION PASSING THROUGH THE OPENING AT 5 INCHES NOMINAL AND 29 INCHES NOMINAL ABOVE THE FINISH FLOOR.

11B-407.3.3.2 CONTACT
 THE DEVICE SHALL NOT REQUIRE PHYSICAL CONTACT TO BE ACTIVATED, ALTHOUGH CONTACT IS PERMITTED TO OCCUR BEFORE THE DOOR REVERSES.

11B-407.3.3.3 DURATION
 DOOR REOPENING DEVICES SHALL REMAIN EFFECTIVE FOR 20 SECONDS MIN.

11B-407.3.4 DOOR AND SIGNAL TIMING
 THE MIN. ACCEPTABLE TIME FROM NOTIFICATION THAT A CAR IS ANSWERING A CALL UNTIL THE DOORS OF THAT CAR START TO CLOSE SHALL BE CALCULATED FROM THE FOLLOWING EQUATION:

$$T = D / (1.5 \text{ FT/S}) \text{ OR } T = D / (457 \text{ MM/S}) = 5 \text{ SECONDS MIN. WHERE T EQUALS THE TOTAL TIME IN SECONDS AND D EQUALS THE TOTAL DISTANCE (IN FEET OR MILLIMETERS) FROM THE POINT IN THE LOBBY OR CORRIDOR 60 INCHES DIRECTLY IN FRONT OF THE FARTHEST CALL BUTTON CONTROLLING THAT CAR TO THE CENTERLINE OF ITS HOISTWAY DOOR.}$$

EXCEPTIONS: 1. FOR CARS WITH IN-CAR LANTERNS, T SHALL BE PERMITTED TO BEGIN WHEN THE SIGNAL IS VISIBLE FROM THE POINT 60 INCHES IN FRONT OF THE FARTHEST HALL CALL BUTTON AND THE AUDIBLE SIGNAL SOUNDED.

11B-407.3.5 DOOR DELAY
 ELEVATOR DOORS SHALL REMAIN FULLY OPEN IN RESPONSE TO A CAR CALL FOR 5 SECONDS MIN.

11B-407.4 ELEVATOR CAR REQUIREMENTS
 11B-407.4.2 FLOOR SURFACES
 FLOOR SURFACES IN ELEVATOR CARS SHALL COMPLY WITH SECTIONS 11B-302 AND 11B-303

11B-407.4.3 PLATFORM TO HOISTWAY CLEARANCE
 THE CLEARANCE BETWEEN THE CAR PLATFORM SILL AND THE EDGE OF ANY HOISTWAY LANDING SHALL BE 1 1/4 INCH MAX.

11B-407.4.4 LEVELING

11B-407.4.5 ILLUMINATION
 THE LEVEL OF ILLUMINATION AT THE CAR CONTROLS, PLATFORM, CAR THRESHOLD AND CAR LANDING SILL SHALL BE 5 FOOT CANDELS MIN.

11B-407.4.8.2 AUDIBLE INDICATORS

11B-407.4.8.2.1 SIGNAL TYPE
 THE SIGNAL SHALL BE AN AUTOMATIC VERBAL ANNUNCIATOR WHICH ANNOUNCES THE FLOOR AT WHICH THE CAR IS ABOUT TO STOP.

EXCEPTION: FOR ELEVATORS THAT HAVE A RATED SPEED OF 200 FT PER MIN OR LESS, A NON-VERBAL AUDIBLE SIGNAL WITH A FREQUENCY OF 1500 HZ MAXIMUM WHICH SOUNDS AS THE CAR PASSES OR IS ABOUT TO STOP AT A FLOOR SERVED BY THE ELEVATOR SHALL BE PERMITTED.

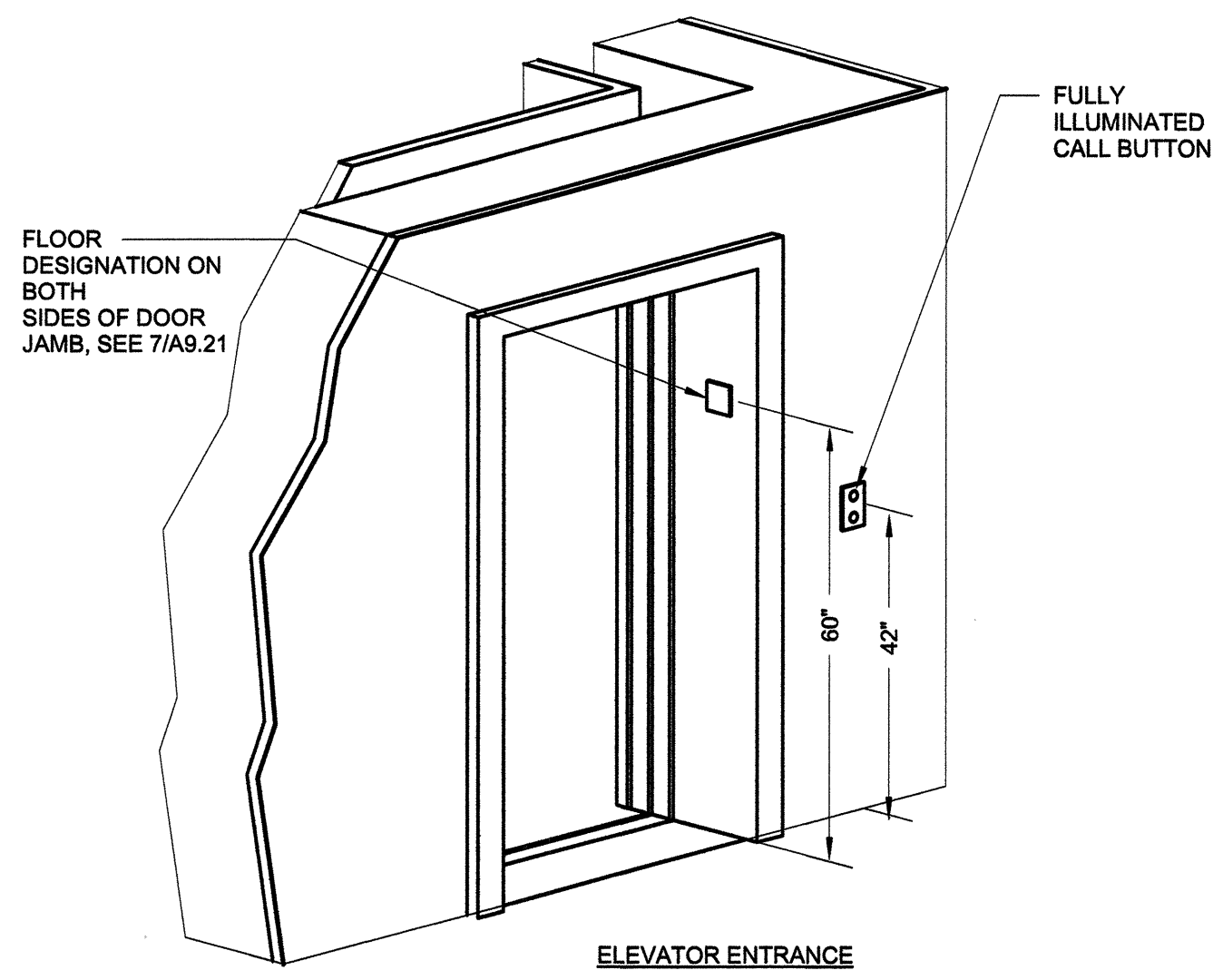

9 ELEVATOR ENTRY_BLDG. 11 1/2" = 1'-0"

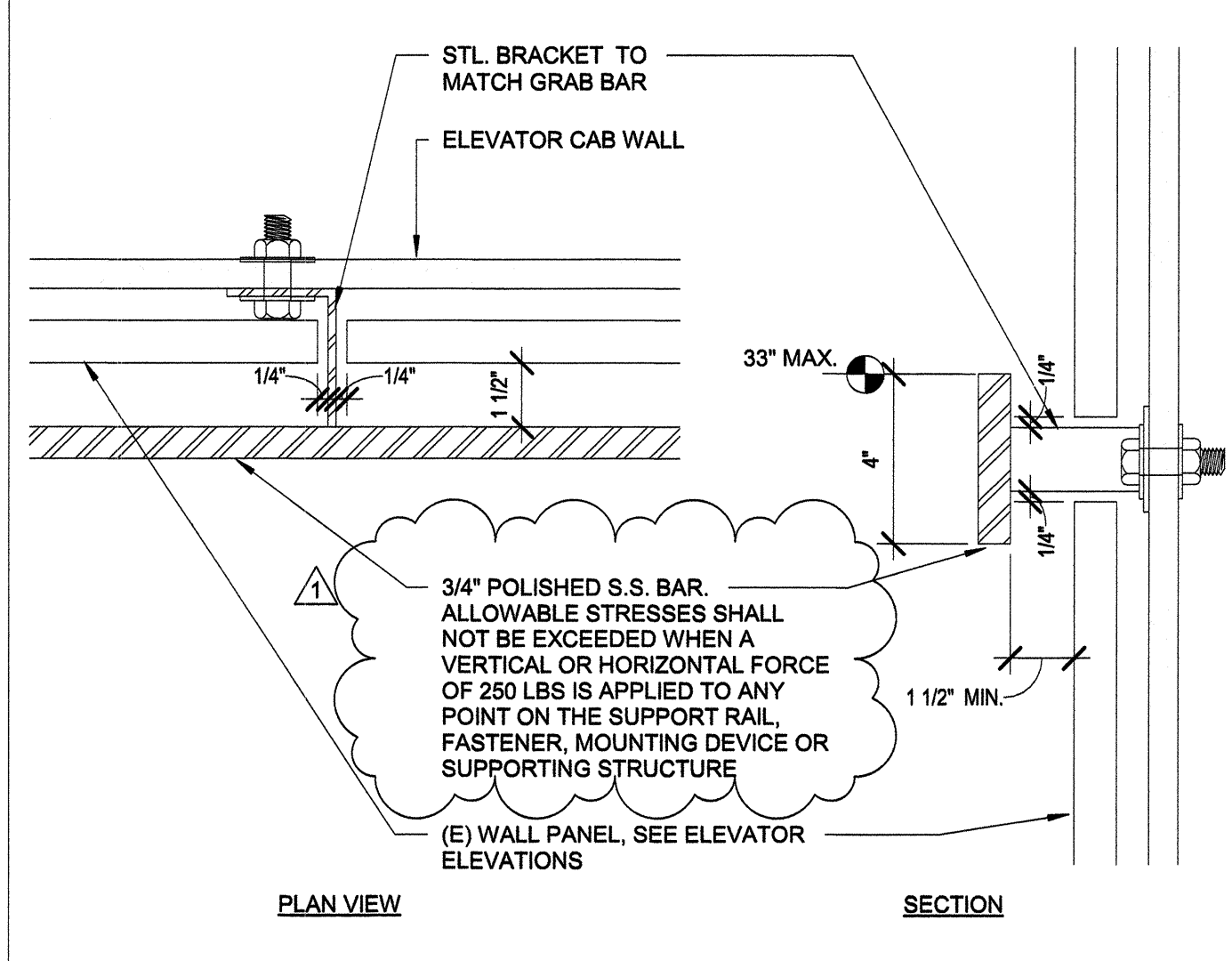

6 ELEVATOR SUPPORT RAIL 3" = 1'-0"

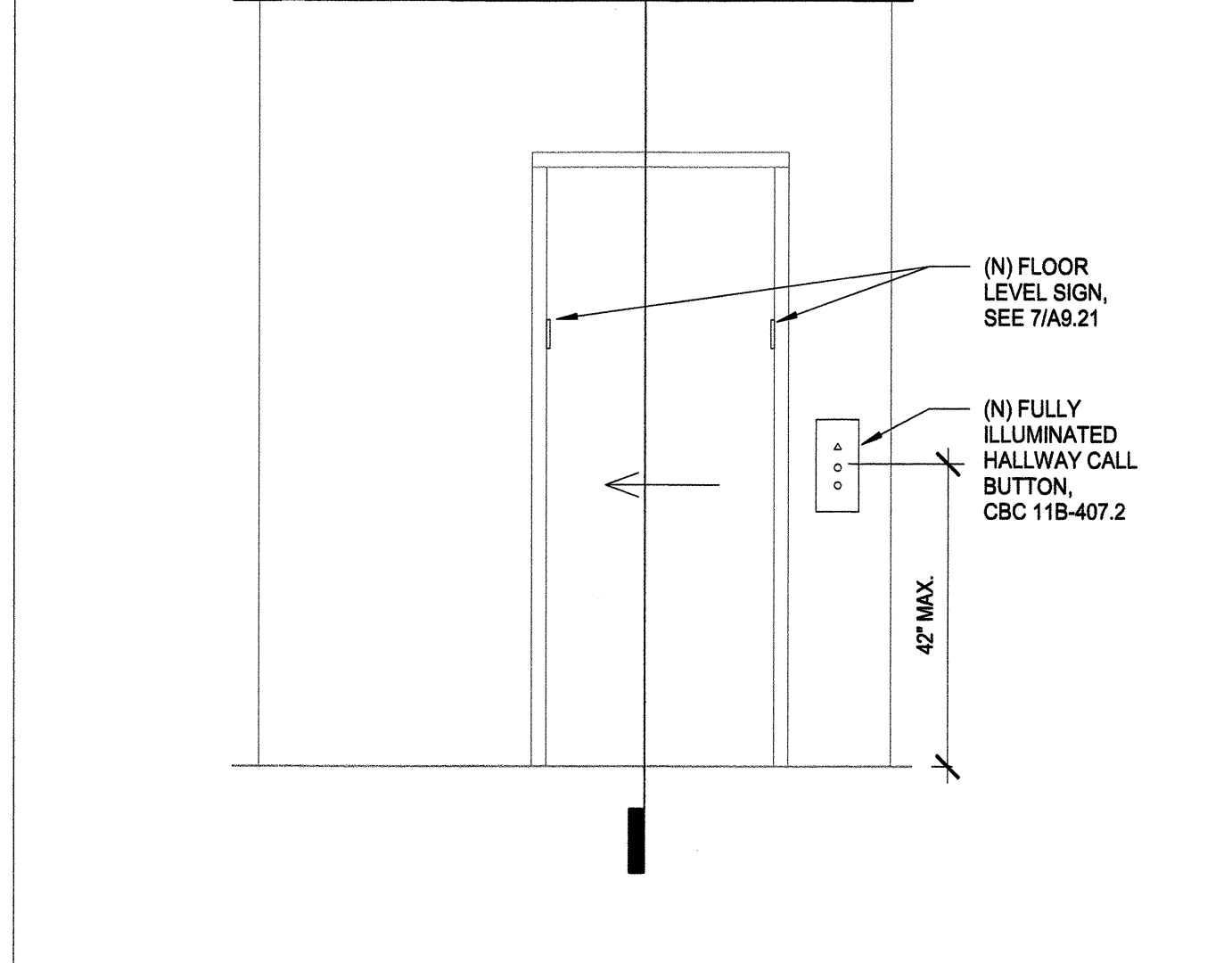

3 ELEVATOR HALLWAY ELEVATION 1/2" = 1'-0"

ELEVATOR CAR CONTROL PER CBC 11B-407.4.6 AND DESIGNATIONS AND INDICATORS FOR CAR CONTROLS PER CBC 11B-407.4.7

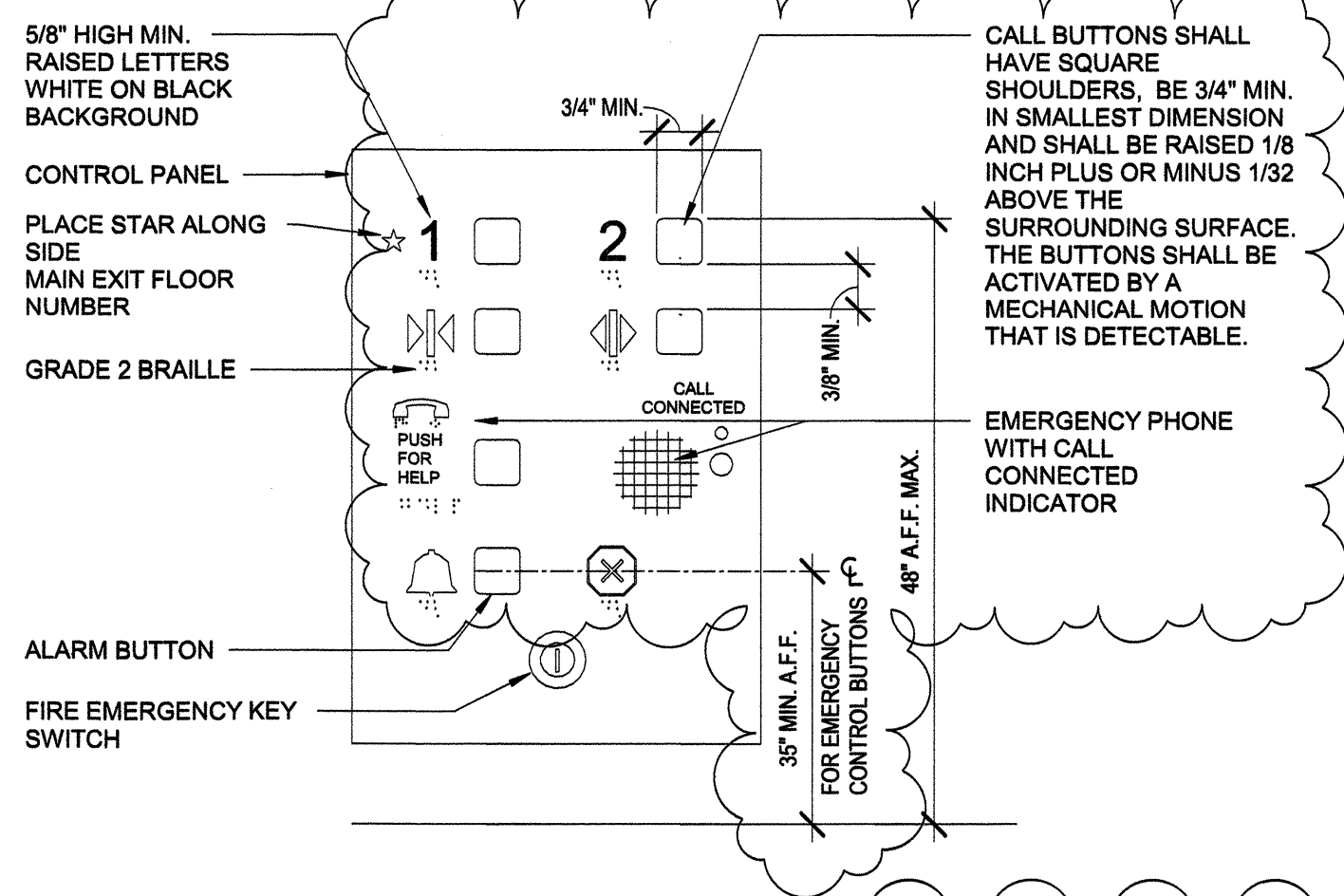

BRAILLE SYMBOLS:
 CALIFORNIA CONTRACTED GRADE 2 BRAILLE SHALL BE USED. DOTS SHALL BE 1/10 INCH (2.54 mm) ON CENTERS IN EACH CELL WITH 3/10 INCH (5.08 mm) SPACE BETWEEN CORRESPONDING DOTS IN ADJACENT CELLS. DOTS SHALL BE RAISED A MINIMUM OF 1/40 INCH (0.635 mm) ABOVE THE BACKGROUND. PER 2016 CBC SEC 11B-703.3

8 ELEVATOR CONTROL PANEL 3" = 1'-0"

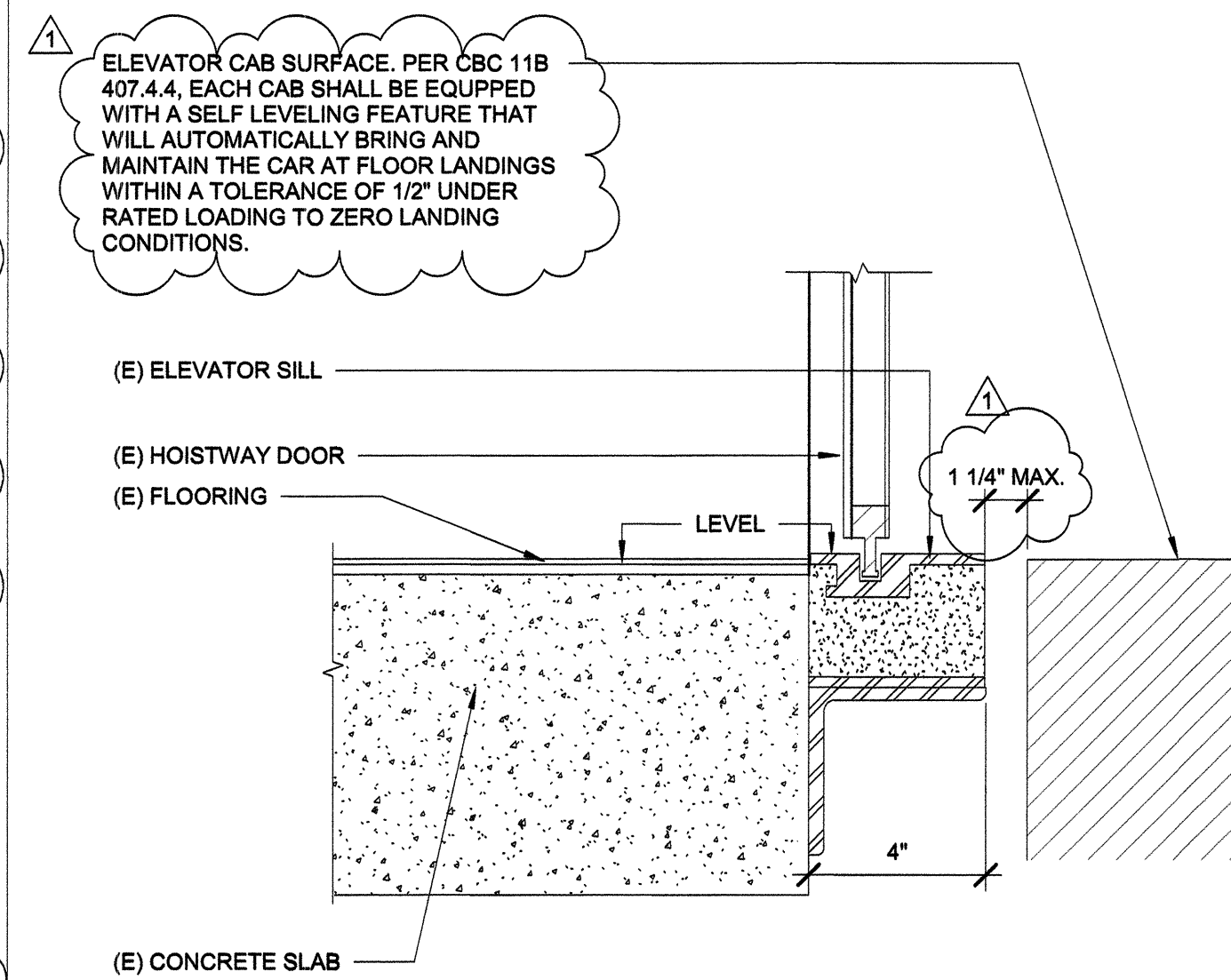

5 ELEVATOR DOOR SILL - CONCRETE 3" = 1'-0"

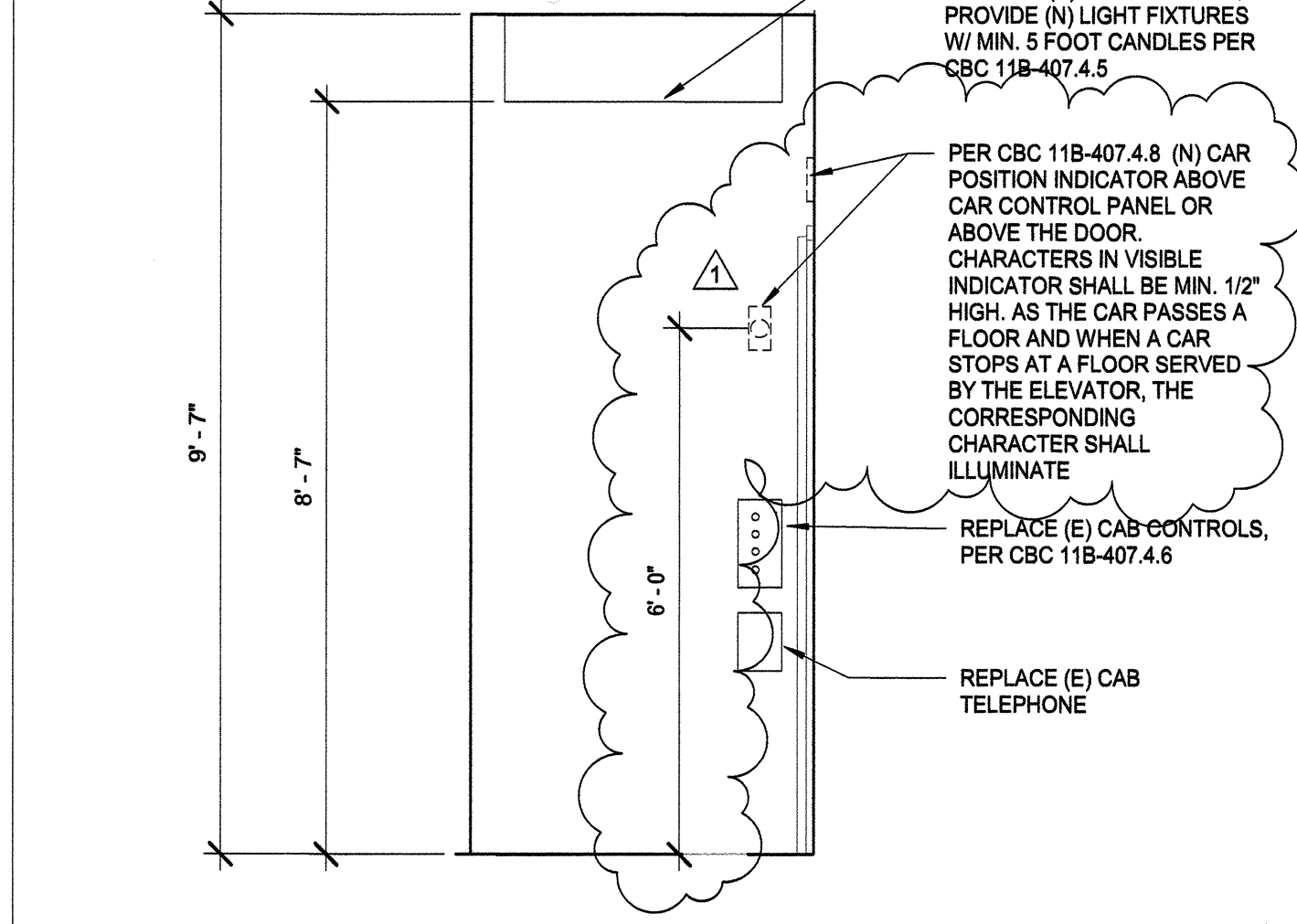

2 ELEVATOR CAB SIDE ELEVATION 1/2" = 1'-0"

ELEVATOR FLOOR DESIGNATION SIGNAGE PER CBC 11B-407.2.3.1

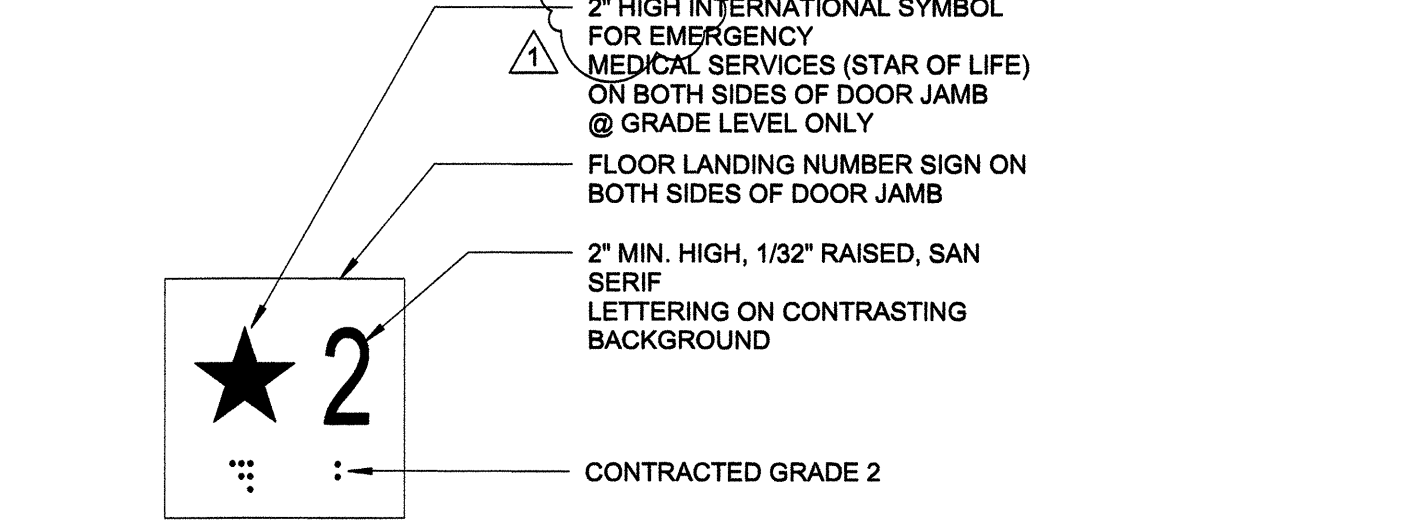

BRAILLE SYMBOLS:
 CALIFORNIA CONTRACTED GRADE 2 BRAILLE SHALL BE USED. DOTS SHALL BE 1/10 INCH (2.54 mm) ON CENTERS IN EACH CELL WITH 3/10 INCH (5.08 mm) SPACE BETWEEN CORRESPONDING DOTS IN ADJACENT CELLS. DOTS SHALL BE RAISED A MINIMUM OF 1/40 INCH (0.635 mm) ABOVE THE BACKGROUND. PER 2016 CBC SEC 11B-703.3

7 FLOOR DESIGNATION SIGNAGE 3" = 1'-0"

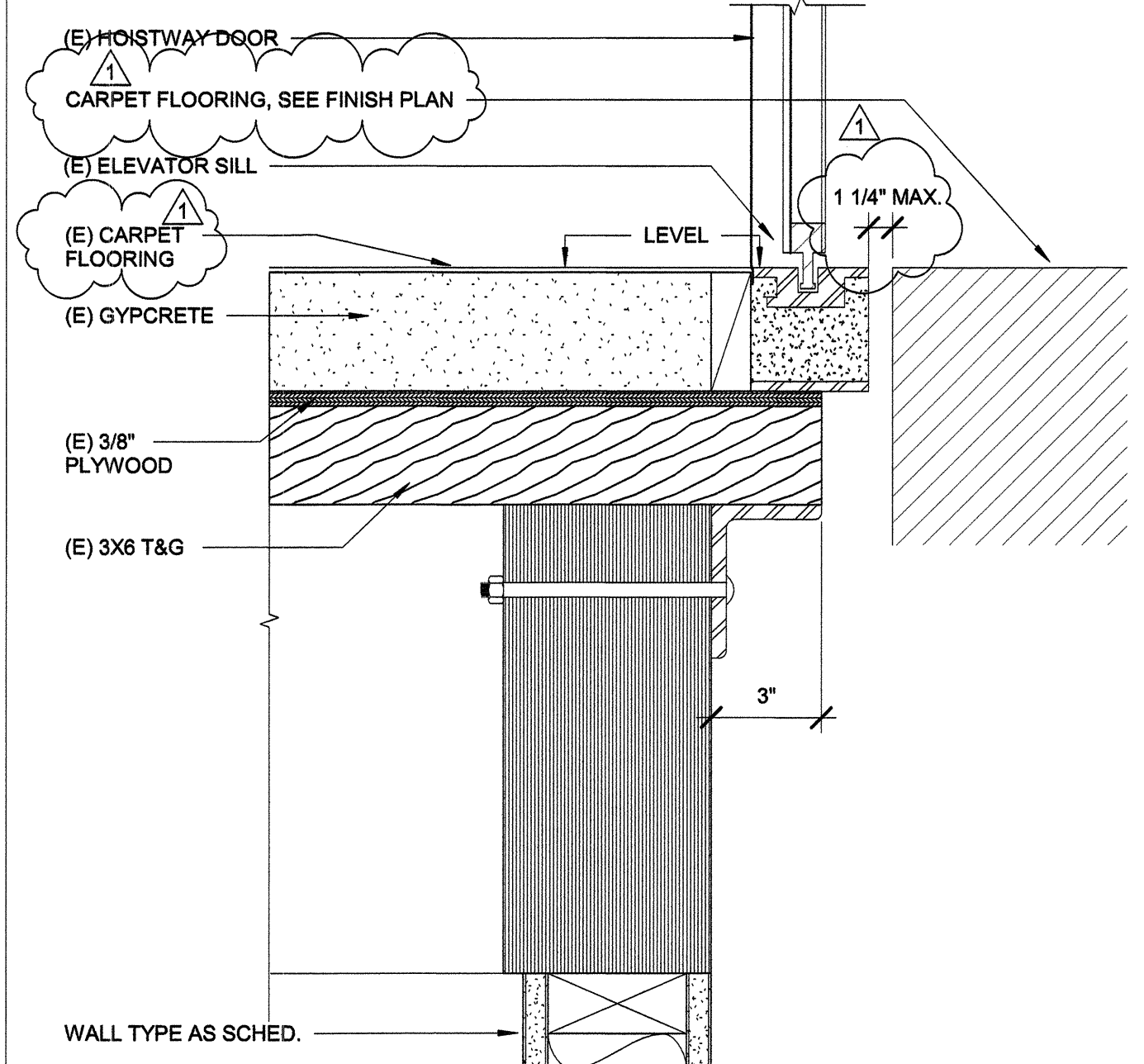

4 ELEVATOR DOOR SILL - WOOD 3" = 1'-0"

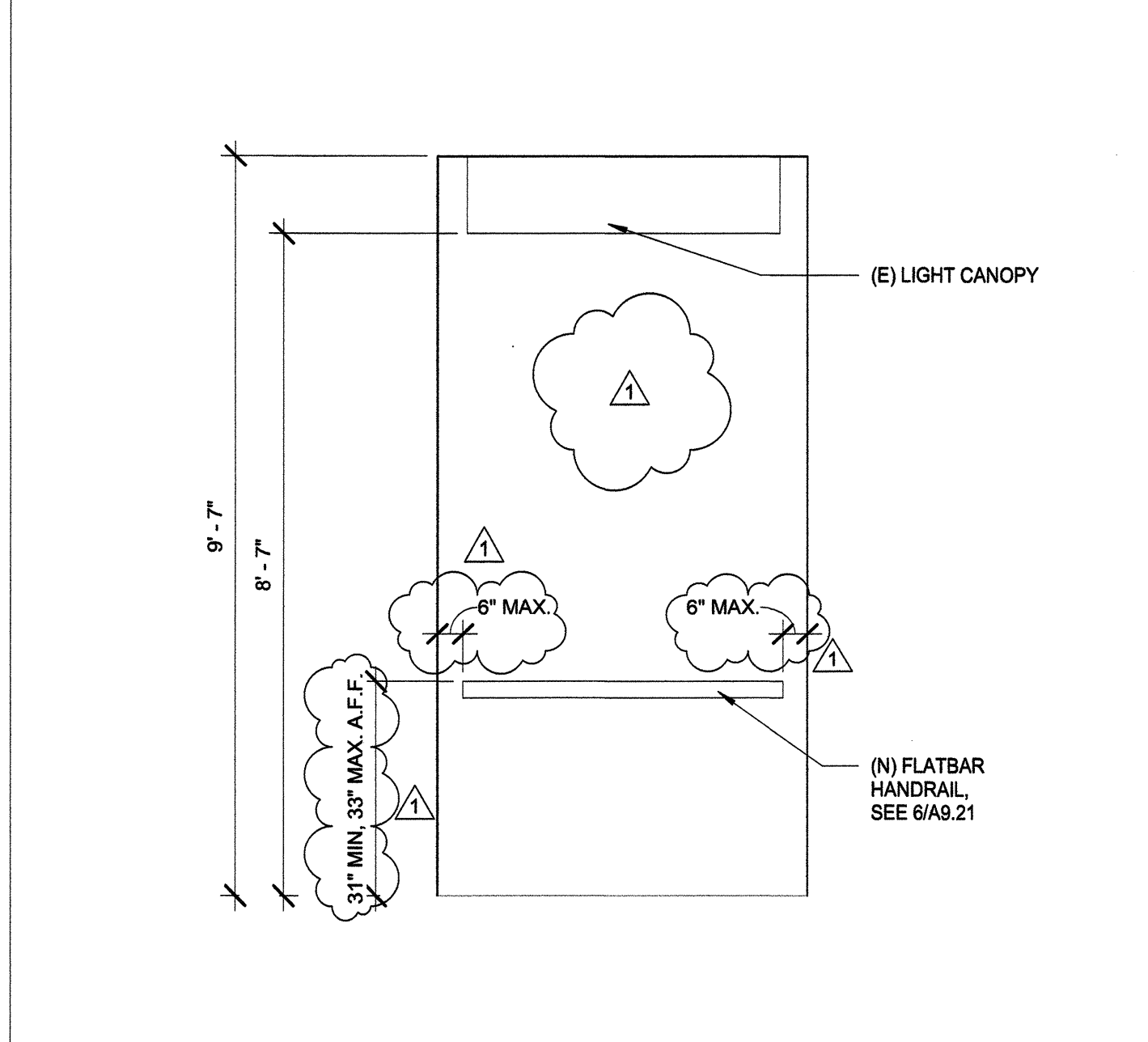

1 ELEVATOR CAB BACK WALL ELEVATION 1/2" = 1'-0"

10 ELEVATOR SPECIFICATIONS

Copyright 2011 Brick, LLP. All Rights Reserved. These Plans and/or Specifications are intended for the sole benefit of the clients of Brick, LLP and may not be used, reused, copied, or reproduced in any form without the express written consent of Brick, LLP.

ARCHITECT
 brick,
 1266 66th street, suite 1
 emeryville, ca 94608
 510.516.0167
 www.brick-llp.com

CLIENT
 marin community college district
 835 college avenue
 kentfield, ca 94904

IDENTIFICATION STAMP
 DIV. OF THE STATE ARCHITECT
 OFFICE OF REGULATION SERVICES
 01-116787
 AC: RE FLS SSS
 DATE

APPROVED
 DIV. OF THE STATE ARCHITECT
 PRE: FLS Edg SS MTF
 REVISION NO. 01- DATE 10-5-17
 116787

10/05/17 ADDENDUM 1
 9/07/17 DSA BACK CHECK
 5/31/17 DSA PLAN REVIEW
 3/10/17 100% CD

rev date issue

REGISTERED ARCHITECT
 STATE OF CALIFORNIA
 C-31415
 10/17
 RENEWAL DATE

COM IVC Bldg. 11
 renovation

novato, california
 project number: 16-148.01

scale: as noted
 date: 09/21/2017

CONSTRUCTION DOCUMENTS
 ELEVATOR DETAILS